

1:8 Optical splitter (LH-OPT-DIST-8CH)

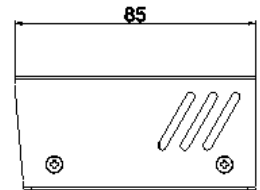
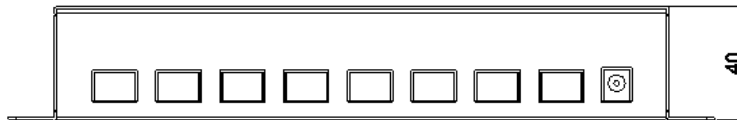
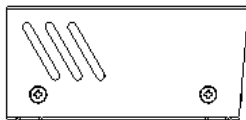
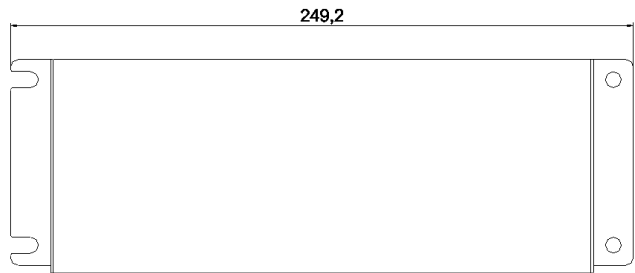

Features

- *. 1 input 8 output LC
- *. Clock-Recovery & 622Mbps Data - Retiming

The Technical Specifications of LH-OPT-DIST-8CH

Descriptions	Specifications	Remarks
1. Power Consumption	7.5W	
2. Operating Voltage	3.3 VDC	
3. Current	2.2A	
4. Input port	Fiber optic LC x 1	
5. Output port	Fiber optic LC x 8	
6. Optical module type	LC	
7. Max. operation distance	Multi-mode : 500M Single >2.5KM	
8. Operating temperature	-20°C ~ +60°C	
9. Weight	720g	
10. Dimension	250mm x 85mm x 40mm	